



Artist Rendering

## FOR ADDITIONAL INFORMATION CONTACT EXCLUSIVE LEASING AGENT

**David Greenman**  
Sr. VP Retail Services  
908.604.6900 Ext. 106  
[dgreenman@silbertrealestate.com](mailto:dgreenman@silbertrealestate.com)

**Brian S. Silbert**  
President & CEO  
908.604.6900 Ext. 116  
[info@silbertrealestate.com](mailto:info@silbertrealestate.com)

**SILBERT**

152 Liberty Corner Road  
Suite 203  
Warren, NJ 07059

REALTY & MANAGEMENT COMPANY, INC.

# Roselle Park 10

**New Mixed-Use Construction**  
**Class-A Ground Floor Retail**  
**with 328 Luxury Apartments**

10 W. Westfield Avenue, Roselle Park  
Union County, New Jersey 07204

### PROPERTY DESCRIPTION

Roselle Park 10 is Roselle Park's newest mixed-use development. With 328 luxury apartments containing 52 two-bedroom, 265 one-bedroom and 11 studios within three, six story buildings. The Meridia at Park Square offers close proximity to the Garden State Parkway (1.3 Mi West), & Route 1 & 9 (1.7 Mi East). Once completed, Roselle Park 10 will be one of the largest mixed-use projects within Union County affording retailers' high visibility along Westfield Avenue a/k/a Route 28. This combined with the dense population (over 30,000 in the 1-mile radius) provide a strong opportunity for retail, food, personal service, and medical uses.

### AVAILABLE SPACE

Building A

- 1,390 SF
- 4,000 SF

Building B

- 3,481 SF

### RENTAL RATES

Upon request, subject to use and creditworthiness

### TRAFFIC COUNT

37,639 VPD Westfield Avenue

### PARKING

Retail garage parking, plus on-site dedicated garage parking for residential tenant parking



Visit Our Website: [WWW.SilbertRealEstate.com](http://WWW.SilbertRealEstate.com)

# BUILDING A LEASING PLAN

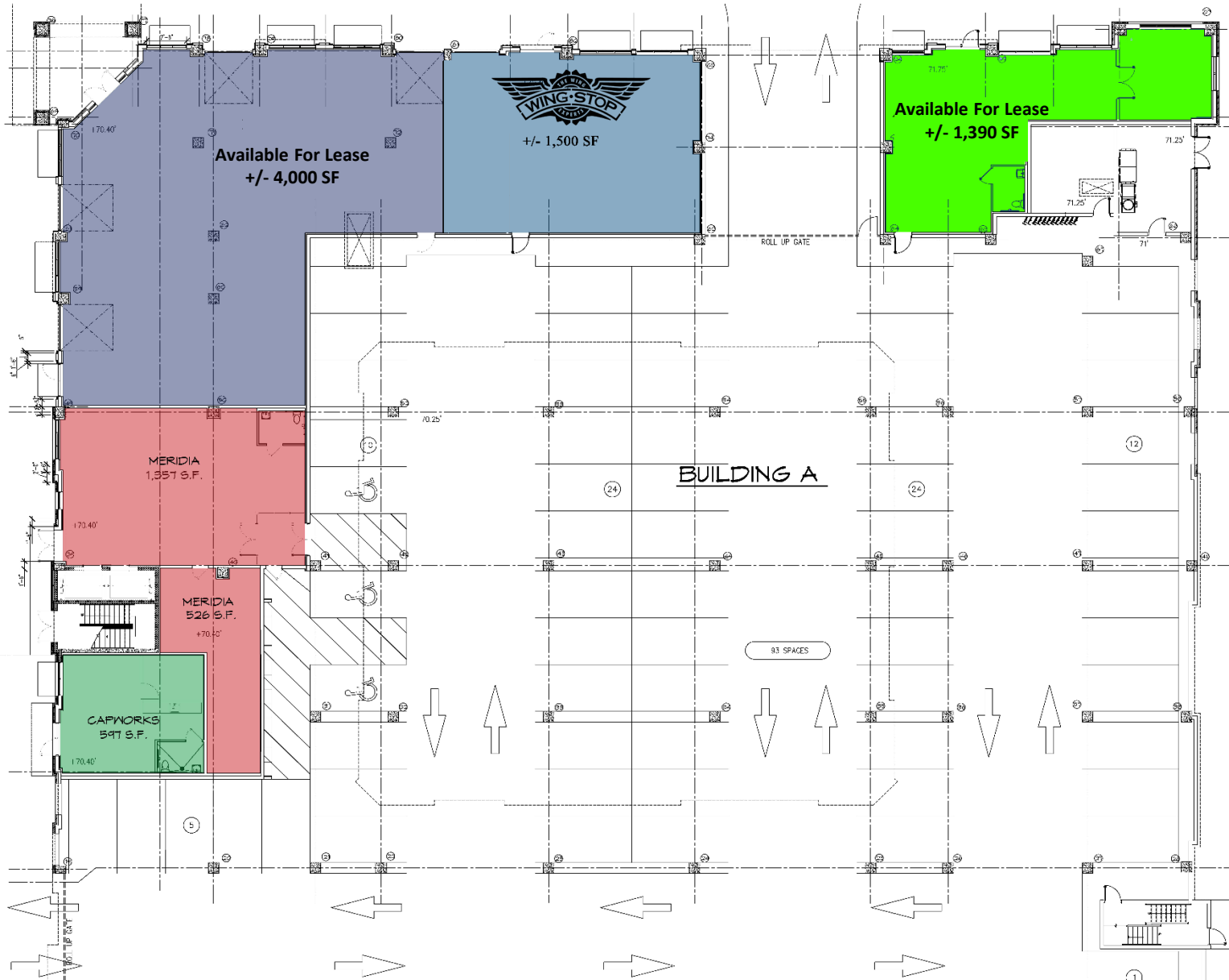



# PROPERTY AERIAL

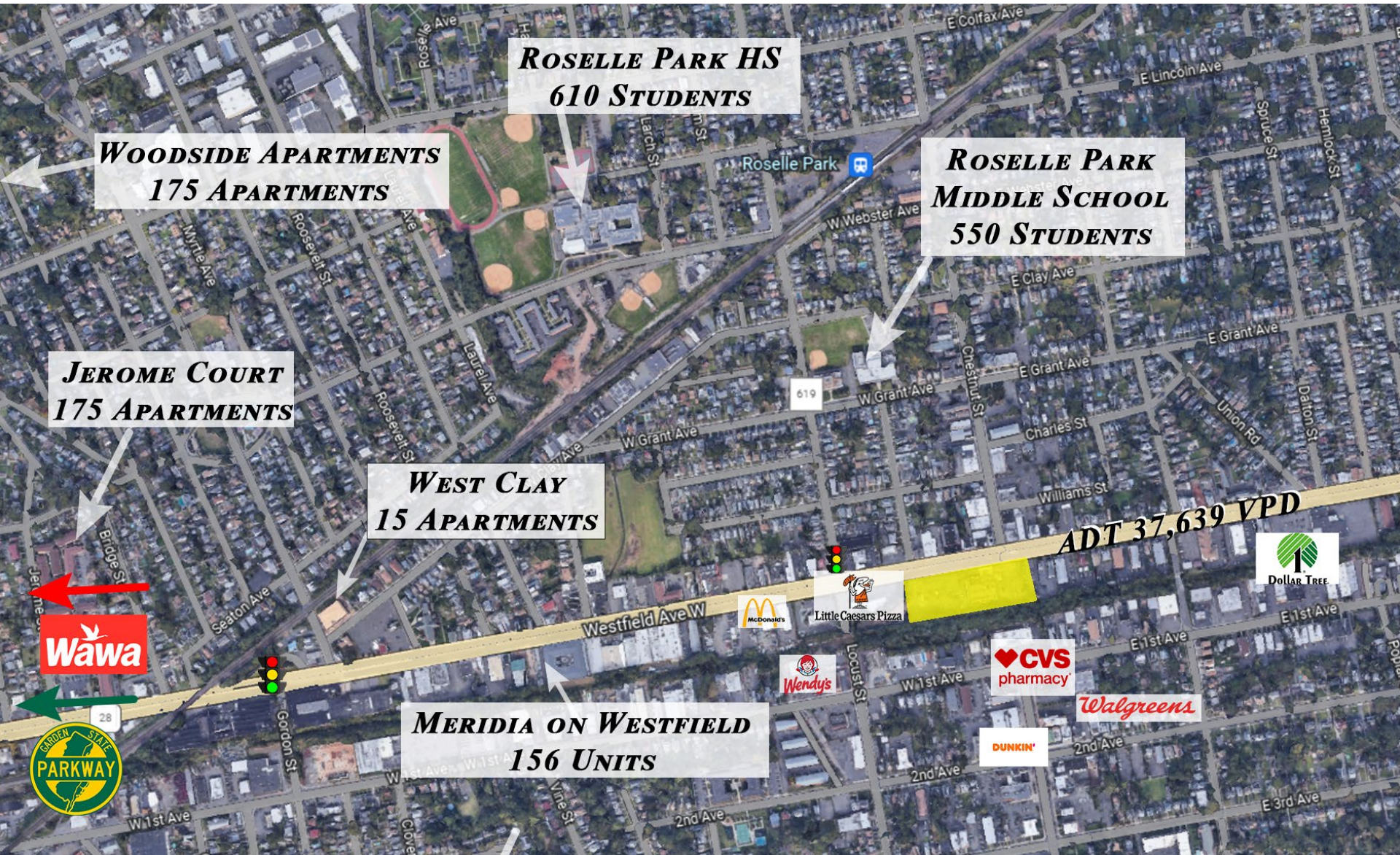

# IMMEDIATE TRADE AREA AERIAL



# AREA DEMOGRAPHICS

## 1 Mile Radius

Population	27,159
Median HH Income	\$81,729
Average HH Income	\$93,861
Median Age	38.0
Total Households	10,043
Daytime Population	17,860

## 2 Mile Radius

Population	99,774
Median HH Income	\$91,706
Average HH Income	\$106,352
Median Age	39.0
Total Households	36,298
Daytime Population	66,617

## 3 Mile Radius

Population	212,056
Median HH Income	\$88,730
Average HH Income	\$104,046
Median Age	38.4
Total Households	76,582
Daytime Population	150,252

