

# WARREN VILLAGE SHOPPING CENTER - KINGS SUPERMARKET ANCHORED

Township of Warren, Somerset County, New Jersey

www.SilbertRealEstate.com

## LOCATION

Signalized intersection Mount Bethel Road and Mountain Boulevard, Township of Warren, NJ 07059

## AVAILABLE SPACE

Unit 1A: 3,200 SF  
Unit 10: 780 SF

## RENTAL RATES

Unit 1A: \$33.00 PSF, NNN  
Unit 10: \$37.00 PSF, NNN  
Real Estate Taxes & CAM for 2012 projected at ±\$8.40 PSF

## OCCUPANCY

Immediate

## PARKING

On site parking for 300 cars

## TRAFFIC COUNTS

14,449 cars per day on Mountain Boulevard  
18,746 cars per day on Mt. Bethel Road

## DEMOGRAPHICS 2010 PROJECTION

### 1 Mile Radius

Population	3,104
Median HH Income	\$145,237
Total Households	1,028
Median Age	42.7
Daytime Population	2,398

### 3 Mile Radius

Population	51,452
Median HH Income	\$88,246
Total Households	18,300
Median Age	40.3
Daytime Population	25,289

### 5 Mile Radius

Population	195,933
Median HH Income	\$77,607
Total Households	70,267
Median Age	38.6
Daytime Population	92,584

## PROPERTY DESCRIPTION

61,000 SF traditional design grocery anchored neighborhood village center, 95% occupied and the premier shopping center in affluent Warren. Renovation and expansion completed in 2008, Warren Village provides detailed finishings and a brick façade for national retailers with convenient pedestrian access and covered walkways. Pylon directory signage and beautifully maintained grounds with walking paths allow for a highly successful, strong tenant mix, affording shoppers a great retail environment.

## COMMENTS

- Affluent Warren with 58% higher education;
- Significant daytime population given major corporate presence including Chubb Insurance & Citigroup;
- Less than 3 miles South of I-78, Exit 36 and 2 miles North of State Highway Route 22 & Warrentown Rd;
- Suitable retail uses may include: health/vitamins, cosmetic/body care, entertainment, apparel, housewares, home furnishings, books/video/music, electronics, nutrition/diet center, computers/software, pet supplies, fitness, childcare/education/play, wine/liquor store



## For Additional Information or Inspection Contact:

William Ray, Managing Director Brokerage, Ext. 19  
wray@silbertrealestate.com

or

Brian S. Silbert, President, Ext. 15  
info@silbertrealestate.com

85A Division Avenue • P O Box 406 • Millington, NJ 07946  
908-604-6900 • 908-604-2030 fax

[www.silbertrealestate.com](http://www.silbertrealestate.com) • email: [info@silbertrealestate.com](mailto:info@silbertrealestate.com)

Developed By:  
The Klein Group &



Although all information furnished regarding property for sale, rental or financing is from sources deemed reliable such information has not been verified, and no express representation is made nor is any to be implied as to the accuracy thereof, and it is submitted subject to errors, omissions, changes of price, rental or other conditions, prior sale, lease or financing, or withdrawal without notice.

# SILBERT

REALTY & MANAGEMENT COMPANY, INC.

# WARREN VILLAGE SHOPPING CENTER - KINGS SUPERMARKET ANCHORED

Township of Warren, Somerset County, New Jersey

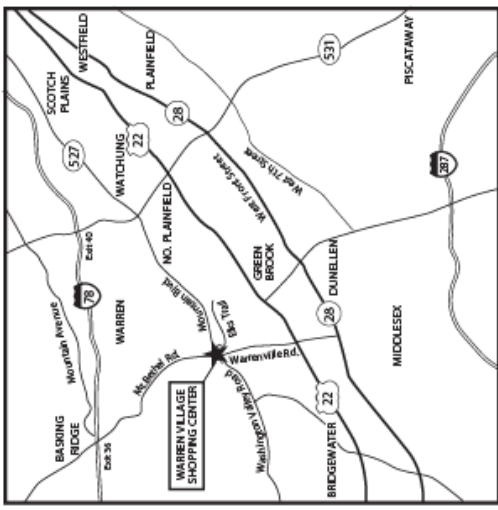

**For Additional Information or Inspection Contact:**  
 William Ray  
 Managing Director Brokerage, Ext. 19  
 wray@silbertrealstate.com  
 or  
 Brian S. Silbert  
 President, Ext. 15  
 info@silbertrealstate.com  
**908-604-6900**

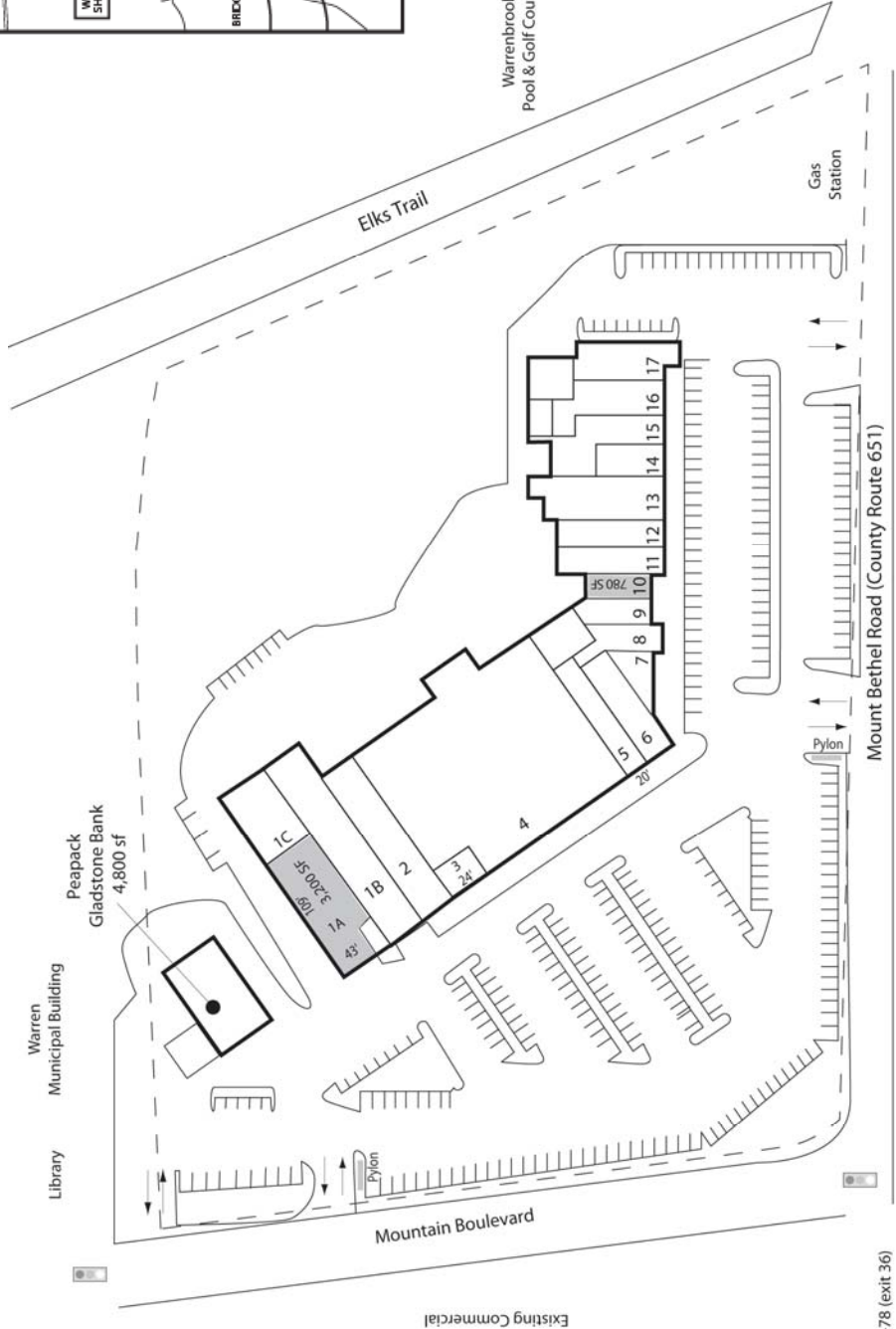

Opposite 78,000 sf A&P Pheasant Run Shopping Center

Existing Professional Offices & Retail

- 1A. **Available**
- 1B. Country Squire Restaurant
- 1C. Remax Realtors
- 2. Edgwood Pharmacy
- 3. Verizon Wireless
- 4. Kings Supermarket
- 5. Muscle Maker Grill
- 6/7. Pizza & Italian Restaurant
- 8. Warren Cleaners
- 9. Warren Eye Care
- 10. **Available**
- 11. UPS Store
- 12. Burgers/Fries
- 13. Massage Envy
- 14. Nail Salon
- 15. European Waxing
- 16. 16 Handles Yogurt
- 17. Starbucks Coffee
- 892 SF
- 780 SF**
- 1,880 SF
- 1,800 SF
- 3,466 SF
- 700 SF
- 1,960 SF
- 1,900 SF
- 2,150 SF
- 3,200 SF**
- 4,500 SF
- 3,418 SF
- 2,900 SF
- 459 SF
- 21,435 SF
- 1,910 SF
- 2,575 SF
- 855 SF

